

415v, 10amp, 3 phase earth + neutral isolator to be supplied by others, approx 1500mm above FFL adjacent to the desired control panel position. Refer to electrical layout for exact arrangement.

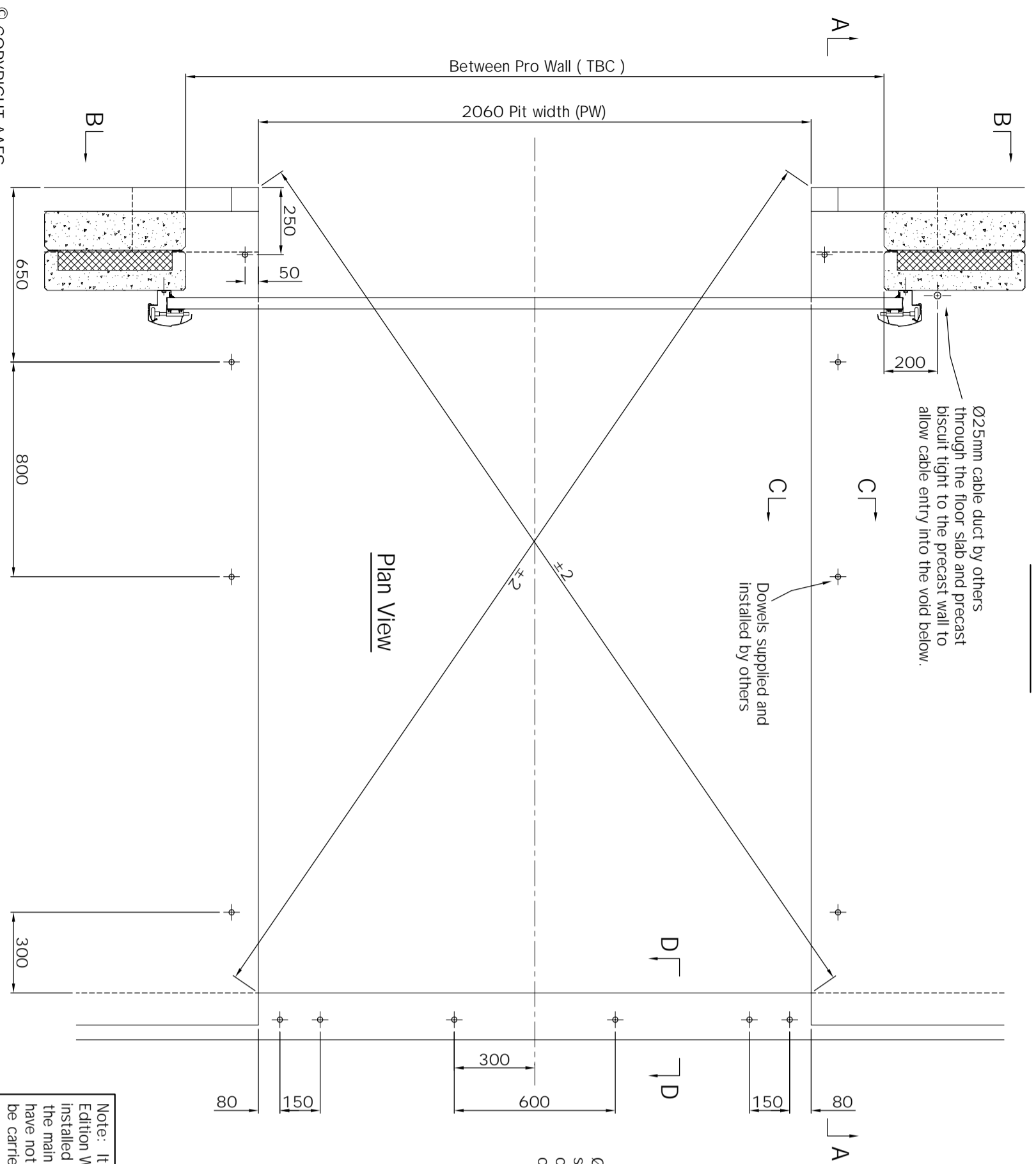
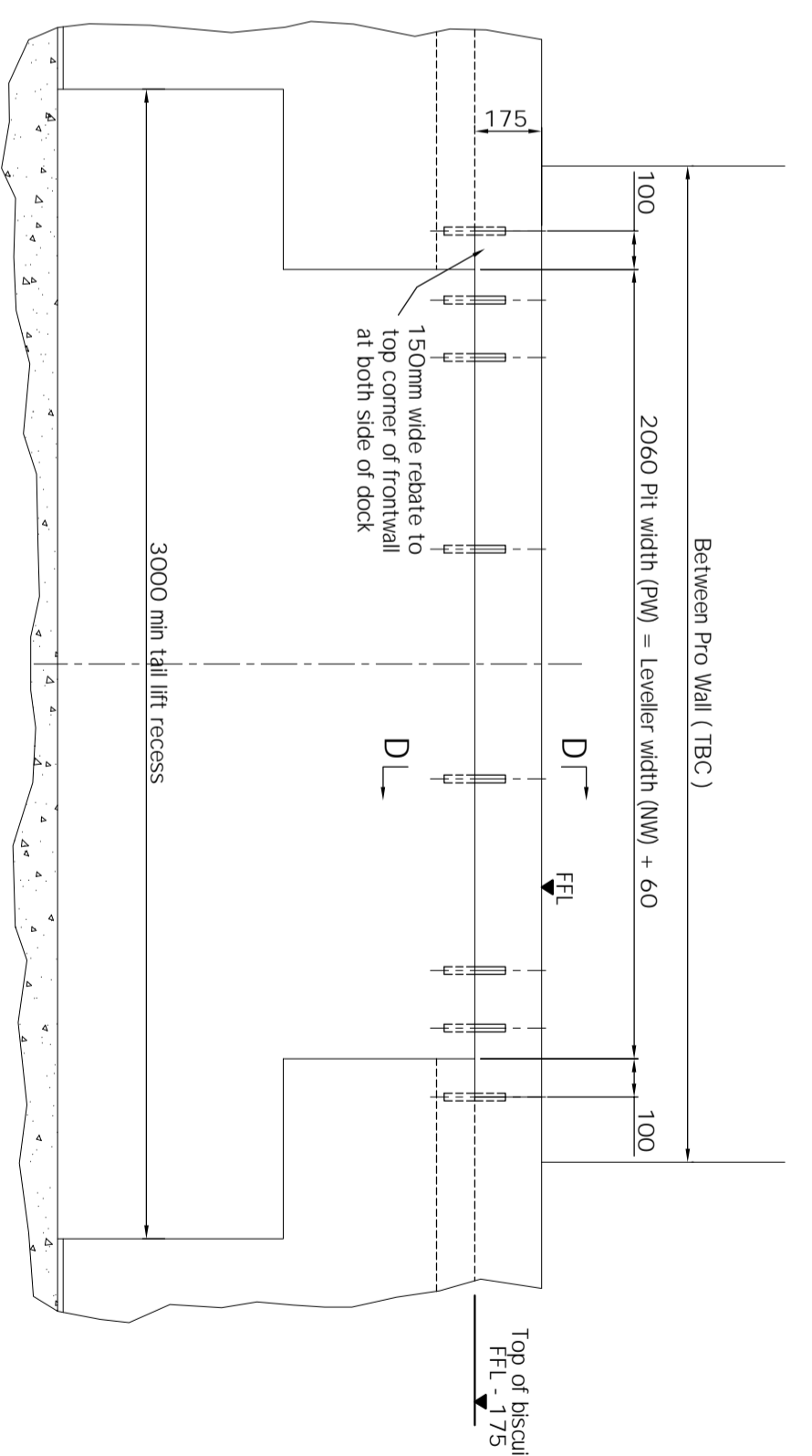
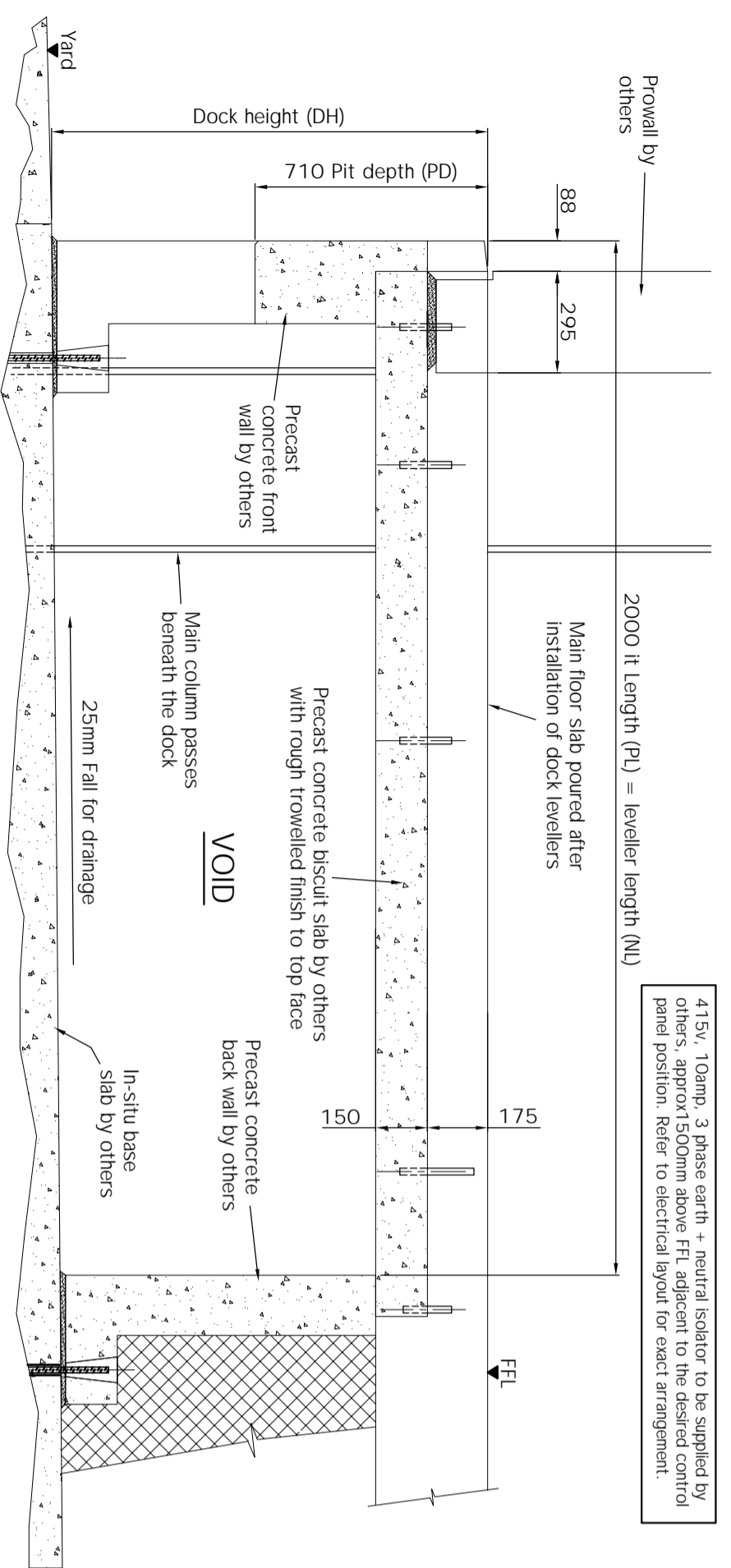

Section A-A

Section B-B

Section C-C

Section D-D

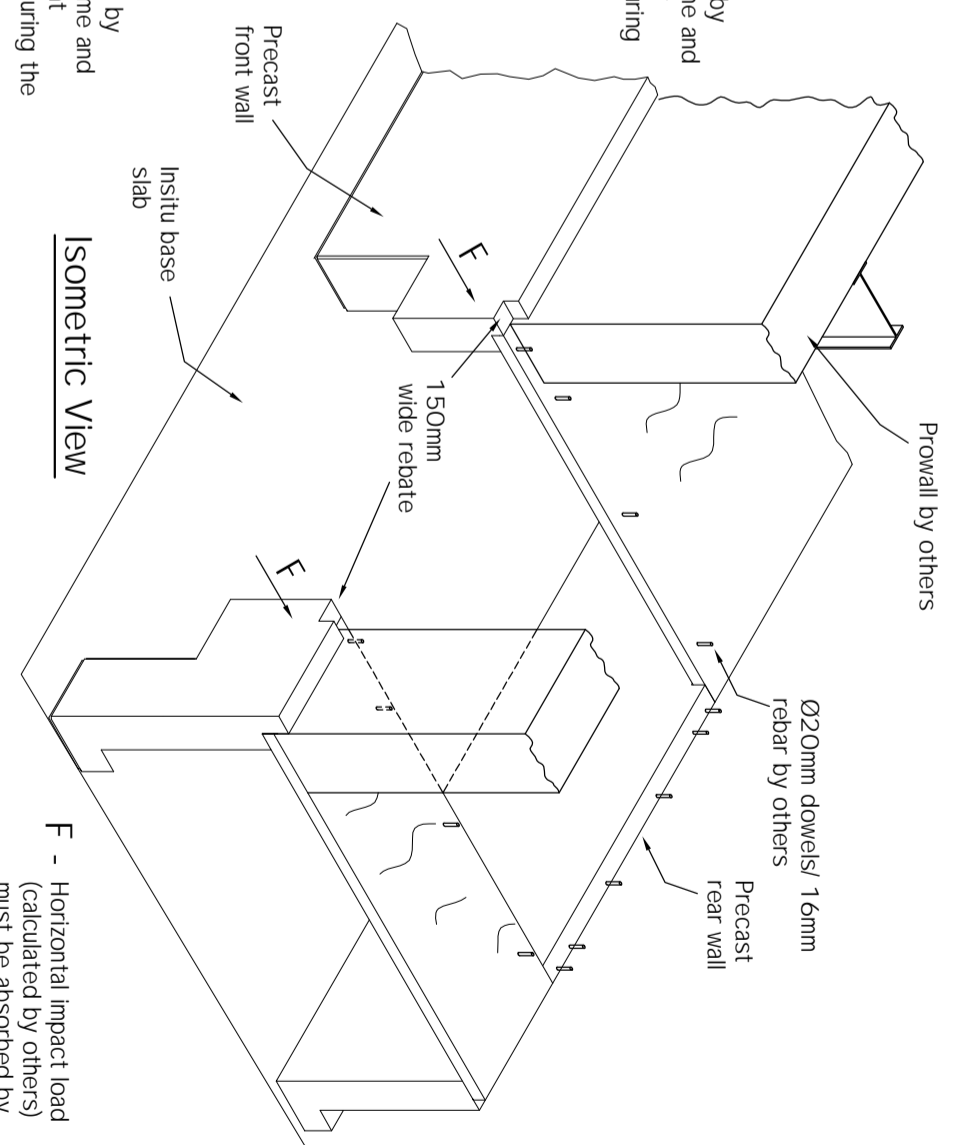

Isometric View

Note: It is a requirement of the I.E.E 16th Edition Wiring Regulations that all steelwork installed into a building must be connected to the main equipotential earth bond. Assa Aabloay have not included for these works and should be carried out by others.

Pos.	Qty.	DH	NL	NW	LH	PL	PW	PD

TOLERANCES +/- 3mm (DO NOT SCALE - if in doubt ask)

SPECIFICATION: SwingDOCK
INSTALLATION TYPE: Frame T200

LIP MATERIAL: Steel Aluminium
LIP LENGTH: 400mm 500mm

LIP OPTIONS:
Standard
Tapered (100mm each side)
Fold Down Segments (1 each side)
Bevelled (Steel Lip - 40mm)
Bevelled (Steel Lip - 100mm)

FINISHES:
Standard Ral 5010 - Blue
Other (specify Ral / BS colour)
Hot Dip Galvanized

ADDITIONAL OPTIONS:
EPDM Seals (to platform perimeter)
40mm Platform Insulation
Anti-slip Surface Protection
Noise Reduction
Low Temperature Oil
Environmental Oil

CONTROL PANEL:
950 L 950 LA
950 DL 950 DLA
950 DLS 950 DLSA

CONTROL OPTIONS:
Integrated Door Control
Integrated Shelter Control
Auto Leveller Retraction

BUFFER OPTIONS:
400x80x70 + 10mm Plate
500x250x90 + 15mm Plate
500x250x140 + 15mm Plate
Floating (EBF)
Height Adjustable (EBH)

NOTES:
F - Horizontal Impact load (calculated by others) must be absorbed by the structure

DRAWN BY:	
CHECKED BY:	
DATE:	
DRAWING NO.	REV.

ASSA ABLLOY

ASSA ABLLOY Entrance Systems Ltd
Industrial Door and Docking Solutions

7Churchill Way .35A Business Park .Chapeltown .Sheffield .UK .S35 2PY
Tel: +44 (0)114 257 4330 Fax: +44 (0)114 257 4399

TITLE: Pit setting out details for SwingDOCK leveller with 6T single axle load. Precast pit with tail lift.

CLIENT:

SITE:

DRAWING STATUS
PRELIMINARY
FOR APPROVAL
CONSTRUCTION
AS BUILT

REV.	BY	DATE	COMMENT